

TRUCK, UTILITY, LIGHTWEIGHT, MC 2 - LANDROVER - ALL TYPES  
FITTING OF ELBOW TO TRANSMISSION DIFFERENTIAL LOCK CONTROL VALVE  
MODIFICATION INSTRUCTION

Issue of this instruction is authorized by CONMEA

Introduction

1. This instruction details the replacement of the straight adapter connecting the vacuum flex line to the differential lock control valve with a 90° elbow fitting to prevent the vacuum line wearing through on the blackout switch terminals. This instruction has been rewritten to include all variants and EMEI VEH G 107-1 and G 157-1 are now cancelled.

Note:

1. NSN and Designation used in this instruction were current at the date of issue. If twelve months or more have expired since issue, the NSN should be checked for supersession.

General

2. Estimated Modification Time. 0.40 (initial planning only).
3. Priority. Group 1.
4. Modification to be applied to. All subject vehicles.
5. Items Affected. Differential Lock Control Valve and vacuum tube.
6. Action Required. By RAEME units authorized to carry out unit, field or base repairs in accordance with WKSP A 850.

TABLE 1 - STORES REQUIRED

Item	NSN	Designation	Qty per Equip
1.	4730-66-128-5935	ELBOW TUBE TO BOSS 1/4 IN TUBE TO 1/8 BSP MALE TURNER Y5 PT NO 0302 7802	1
2.	8030-66-113-0738	SEALANT PIPE THREAD LOCTITE 567 50 ML TUBE	AS REQUIRED

TABLE 2 - STORES REMOVED (To be disposed of in accordance with GEN P series)

Item	NSN	Designation	Qty per Equip
1.	4730-66-128-4506	ADAPTER, STRAIGHT PIPE TO TUBE 1/8 IN BSP, 1/4 IN TUBE	1

Detail

7. The modification is to be carried out as described below:
  - a. Remove the passenger seat, and disconnect the battery.
  - b. Remove the two screws securing the top cover to the dash panel (cargo) or the four screws securing the upper instrument panel (FFR variants). Remove the cover after disconnecting the inspection light socket wires.

- c. Using a small screwdriver, slacken the screw retaining the blackout switch knob and remove the knob.
- d. Push in the spring - loaded pin and remove the dimmer switch knob.
- e. Using a 6 mm open ended spanner, secure the shaft on the differential lock control valve and unscrew the knob.
- f. Remove the two screws securing the fascia plate and mounting plate to the dash panel.
- g. Lift the mounting plate assembly sufficiently to gain access to the items shown in Fig. 1.

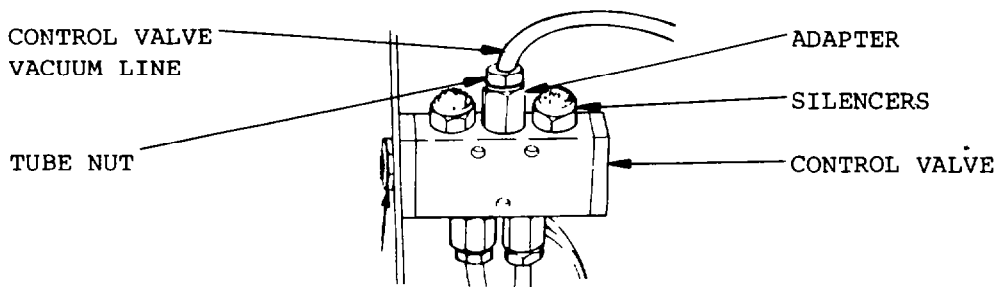

FIG 1 - CONTROL VALVE ASSY

- h. Unscrew the vacuum pump to control valve vacuum line and remove the adapter from the control valve.
- i. Remove the two silencers and retain them.
- j. Place a liberal amount of sealant (item 2 from Table 1,) onto the male thread end of the elbow.
- k. Screw the elbow into the centre port and tighten. Continue to tighten further until the elbow is positioned as shown in Fig 2.

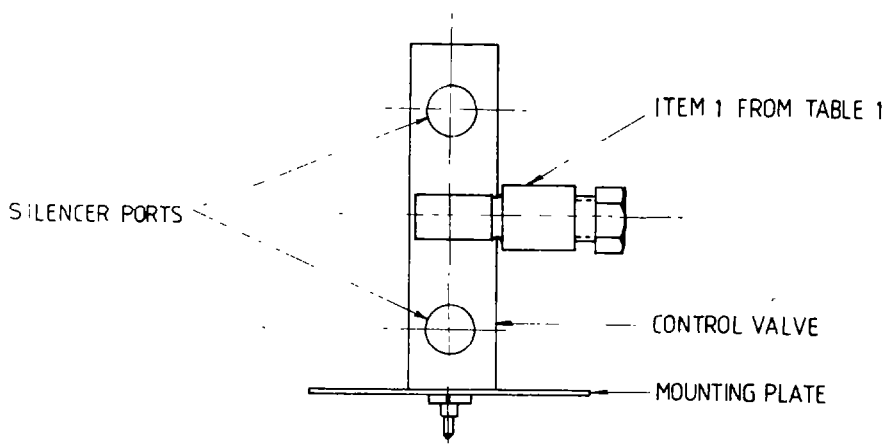

FIG 2 - POSITION OF ELBOW

- l. Refit and tighten the two silencers previously removed.

- m. Unscrew the elbow fitting until the lower edge of the elbow just contacts the silencer as shown in Fig.3.

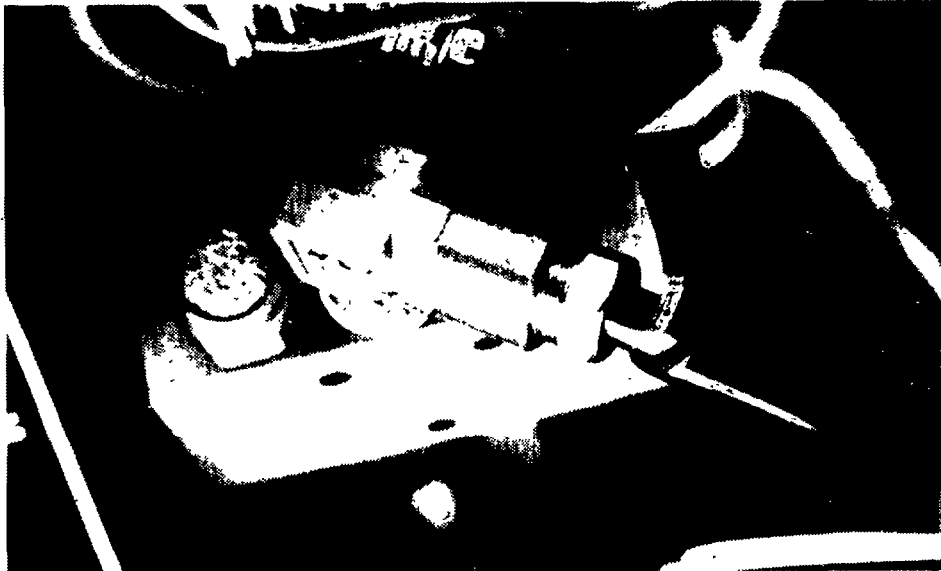

FIG 3 - FINAL POSITION OF ELBOW

- n. Position the mounting bracket and fascia plate on the dash panel and secure with the two screws, ensuring all electrical wires are moved from possible damage.
- o. Refit the blackout, dimmer and control valve knobs.
- p. Remove the retaining tape from the vacuum tube and discard it.
- q. Straighten the vacuum tube assy and force the outer sleeve down along the tube leaving approximately 150 mm of plastic tube bare.
- r. Shorten the vacuum tube by 140 mm ensuring the tube is cut square.
- s. Remove the tube nut and olive from the replacement elbow and place them over the tube.
- t. Position the tube in the elbow and whilst maintaining a slight pressure, tighten the tube nut securely.
- u. Connect the battery, start the engine and run for approximately 30 seconds.
- v. Switch the engine off. Operate the control valve and listen for noise emission through the silencer.
- w. Start the engine and operate for a further 10 seconds. Switch off the engine.
- x. WAIT ONE MINUTE. Operate control valve.

Note:

1. If NO noise is audible from the silencers, check for leaks and rectify.
- y. Re-connect inspection light socket wires to their respective terminals and refit the top cover (cargo) or upper instrument panel (FFR variants).
- z. Road Test the vehicle and check braking and differential lock for satisfactory operation.

Modification Record Plate

8. Deface the numeral 3 on the modification record plate fitted to the drivers seat base.

Recording

9. Enter the details of the modification in Part Three of the TGM 120 Record Book for Service Equipment of subject vehicle. Those vehicles which have been previously modified vide EMEI VEH G 107-1 and G 157-1 are to have the entry in Part Three of the TGM 120 amended to read EMEI VEH G 197-11.

E N D