

TRUCK, UTILITY, LIGHTWEIGHT, MC2 LAND ROVER 110 - ALL TYPES  
TRUCK, CARGO, LIGHT, MC2 LAND ROVER 110 - ALL TYPES

FITTING OF AN EXTRA EARTH STRAP

MODIFICATION INSTRUCTION

Issue of this instruction is authorized by CONMEA

This EMEI is authorised for issue by the authority of the CGS. It provides direction and mandatory controls and procedures for the maintenance and support of equipment. Personnel are to obey the instructions and follow the procedures contained in this publication.

Introduction

1. This instruction details the fitting of an extra earth strap to provide an additional earthing point at the rear of the transmission.

Note:

1. NSN/MPN and Designation used in this instruction were current at the date of issue. If twelve months or more have expired since issue, the NSN/MPN should be checked for supersession.

General

2. Estimated Modification Time. 0.10 hrs (initial planning).
3. Priority. Group 2.
4. Modification to be Applied to. All subject vehicles.
5. Items Affected. Battery earth lead and transmission.
6. Action Required. By RAEME units authorised to carry out unit, field and base repairs.

TABLE 1 - STORES REQUIRED (To be demanded through normal supply channels)

Item	MPN/NSN	Designation	Qty per Equip
1.	BYG 9253	CABLE EARTH	1
2.	5305-99-122-5366	BOLT	1
3.	5310-99-138-9227	WASHER LOCK	1
4.	5310-66-122-6475	WASHER	3
5.	SH108301	BOLT 30MM (6x6 only)	1

Detail

7. The modification is to be carried out as follows:
  - a. Using the existing bolt on the 4x4 Landrover, fit one end of the earth strap (Item 1 from Table 1) to the top rear bolt of the transmission mount as shown in Fig 1.
  - b. On the 6x6 Landrover, remove the top rear bolt of transmission mount and discard. Replace with item 5 from Table 1 and fit one end of the earth strap using items 1 and 4 as shown in Fig 1.

UNCONTROLLED WHEN PRINTED

- c. Fit the other end of the lead to the rear of the transmission using items 2, 3 and 4 from Table 1, as shown in Fig 1.

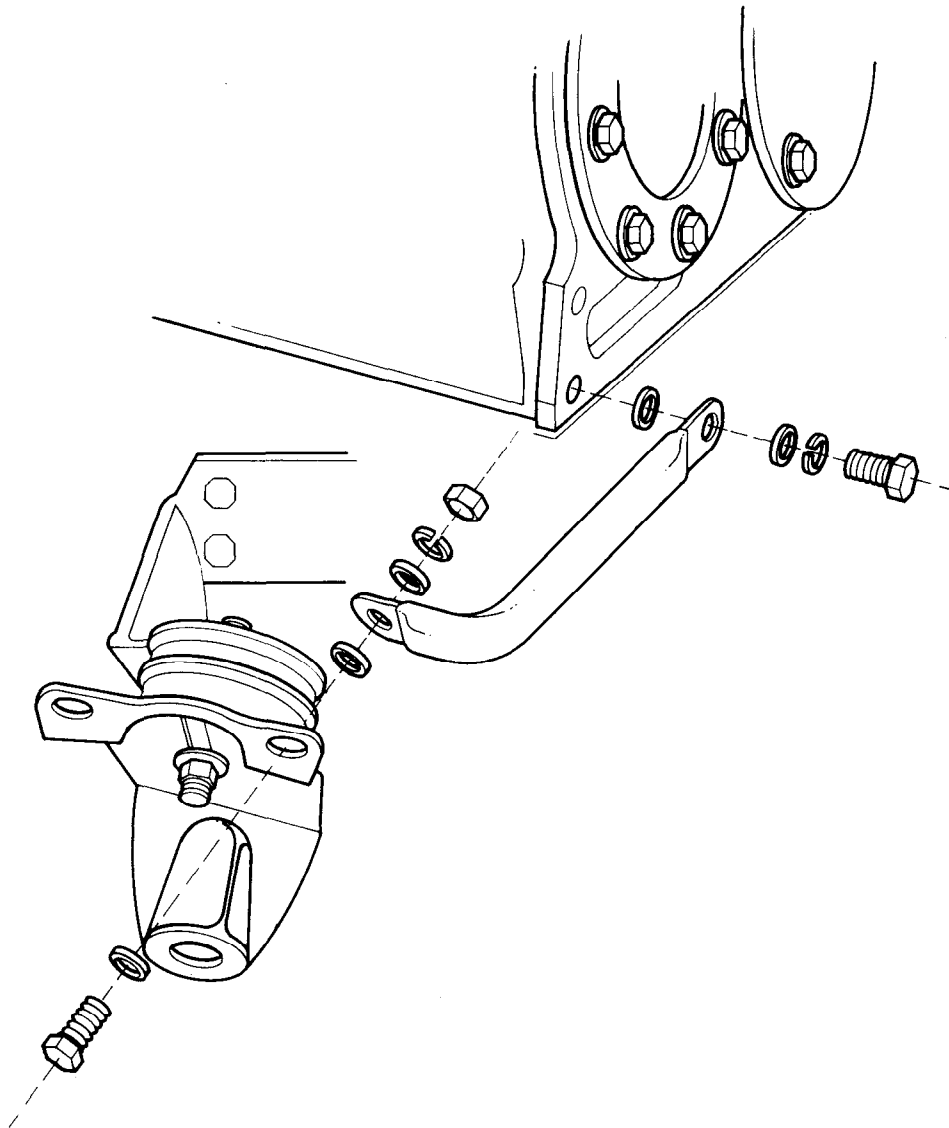

FIG 1 - EARTH STRAP MOUNTING

8. Modification Record Plate. Deface the numeral 15 on 4 by 4 variants and the numeral 7 on 6 by 6 variants, on the modification plate located on the drivers seat base.
9. Recording. Enter the details of the modification in Part Three of the TGM 120, Record Book for Service Equipment, of the subject vehicles.

E N D