

TRUCK PANEL, LIGHTWEIGHT, FFR, MC2, LANDROVER 110
TRUCK UTILITY, LIGHTWEIGHT, FFR, W/WINCH, MC2, LANDROVER 110
MODIFICATION INSTRUCTION
NUMBER PLATE LIGHT PROTECTION

This EMEI is authorised for issue by the CGS. It provides direction, mandatory controls and procedures for the maintenance and support of equipment. Personnel are to obey the instructions and follow the procedures contained in this publication.

Introduction

1. This instruction details the manufacturing and fitting of a protector plate to the number plate light to stop damage occurring when personnel are embarking from the rear of vehicle.

Note:

1. NSN and Designation used in this instruction were current at the date of issue. If twelve months or more have expired since issue, the NSN should be checked for supersession.

General

2. Estimated Modification Time. 1.30 hrs (initial planning only).
3. Priority. Group 2.
4. Modification to be Applied to. Truck Utility Lightweight FFR MC2 and Truck Utility Lightweight MC2.
5. Items Affected. Number Plate Light.
6. Action Required. By RAEME units authorised to carry out unit, field or base repairs.

TABLE 1 - STORES REQUIRED (To be demanded through normal supply channels)

Item	NSN	Designation	Qty per Equip
(a)	(b)	(c)	(d)
1.	9515-66-097-0446	METAL BAR, CARBON STEEL, 25MM W BY 3MM THK	As required
2.	9520-66-097-0460	STRUCTURAL ANGLE, CARBON STEEL, 51MM BY 51MM BY 3MM THK	As required
3.	5305-66-014-8482	SCREW, MACHINE BSF, COUNTERSUNK 1/4 INCH BY 2 INCH LG	2
4.	5310-66-010-7817	NUT, SELF LOCKING, BSF, 1/4 INCH	2
5.	5310-66-015-5872	WASHER, LOCK, SPRING, 1/4 INCH	2
6.	5310-66-012-6847	WASHER, FLAT, 1/4 INCH	2

Note:

1. Ensure lights are turned off before commencing modification.

UNCONTROLLED WHEN PRINTED

Detail

7. The modification is to be carried out as described below:
- Disconnect the electrical wire terminal to the number plate light.
 - Remove number plate light from vehicle and dismantle number plate light assembly.
 - Remove the two small studs in the number plate light backing plate and drill existing holes to 1/4 inch.
 - Manufacture the protector plate and backing strip (Item 1 and 2 from Table 1) as shown in Fig 1.

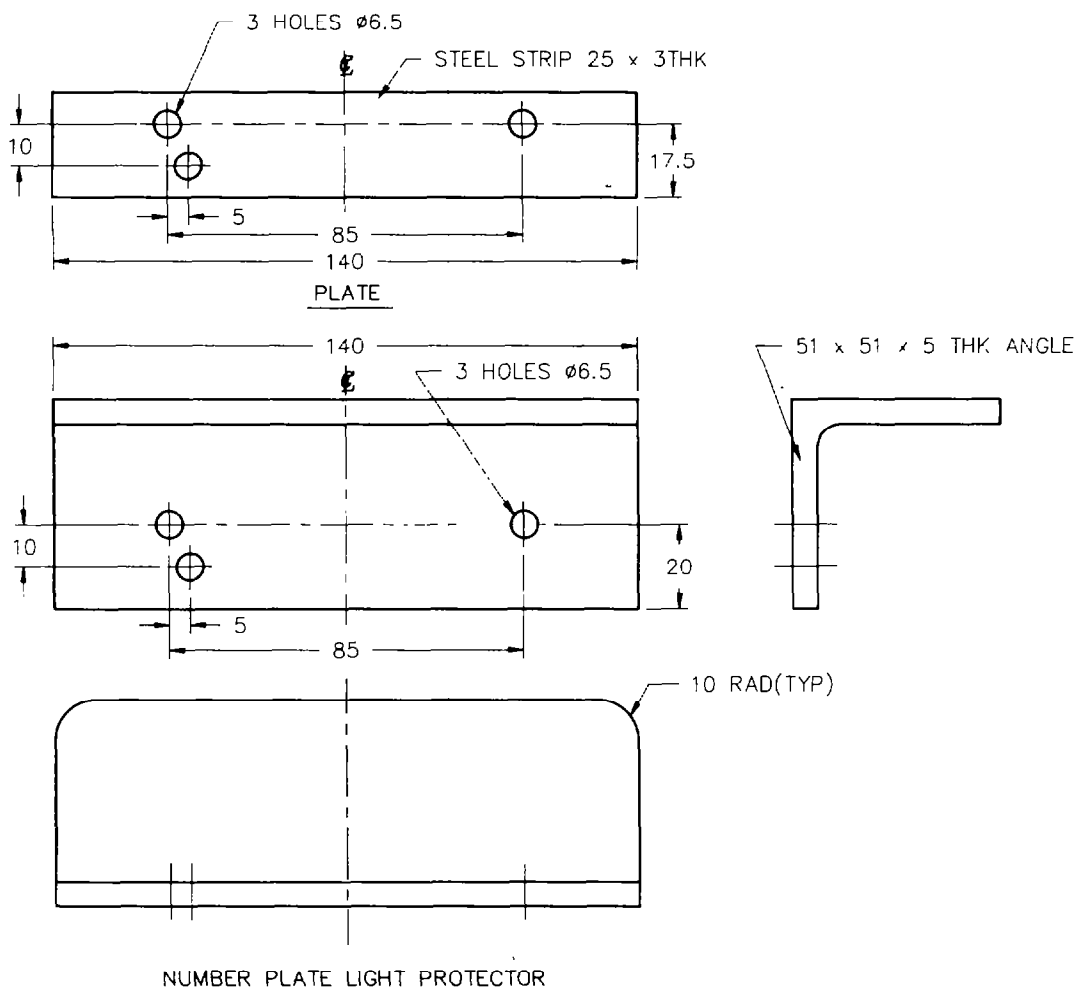

FIG 1

- Insert new screws (Item 3 from Table 1) into number plate light backing plate.
- Assemble number plate backing plate with seal and fit to protector plate.
- Fit protector plate and number plate light to vehicle as shown in Fig 2.

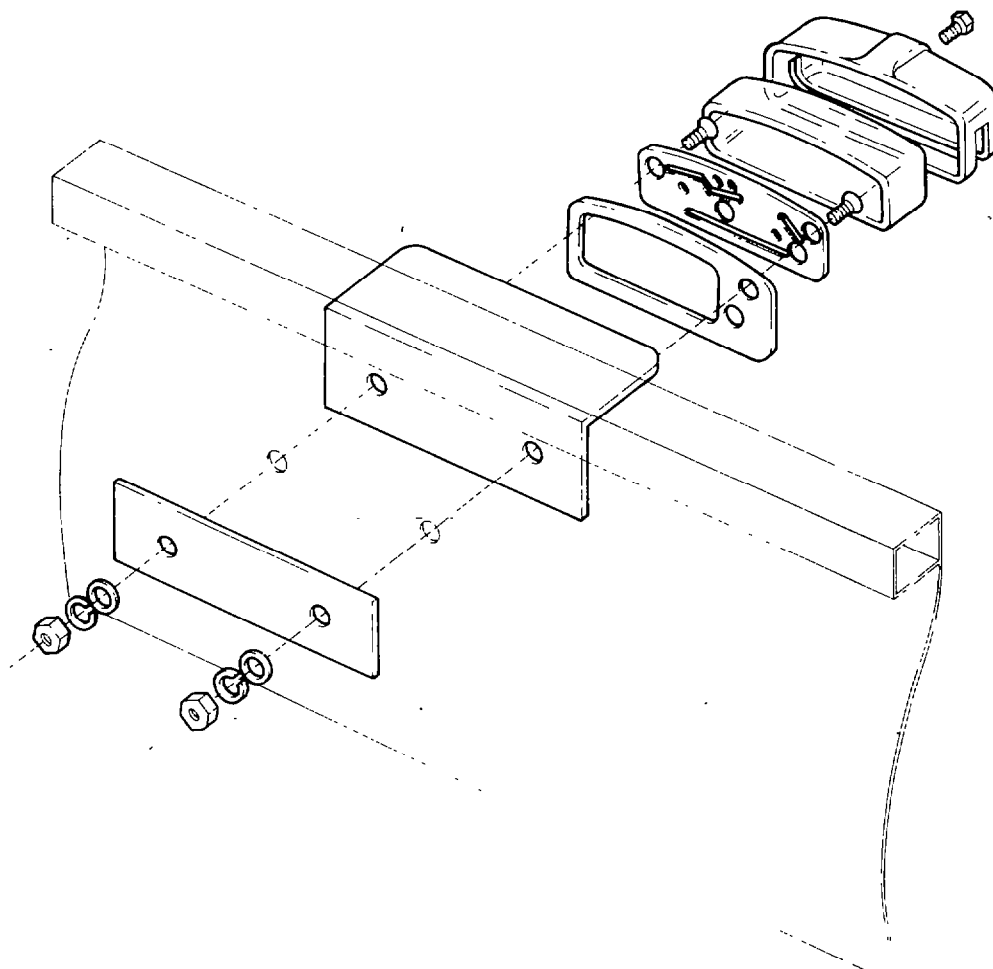

FIG 2

- h. Place protector plate backing plate on from the inside of the vehicle using Item 4, 5 and 6 from Table 1.

Note:

1. When assembling ensure the electrical wire plastic protector sleeve is left on to insulate the electrical wire.
 - i. Connect the wire terminals to the number plate light and turn on the parking lights to ensure the light works.
 - j. Assemble the number plate light assembly and paint protector plate in accordance with EMEI WKSP D 700.
8. Modification Record Plate. Deface the numeral 19 on the modification plate located on the drivers seat base.
9. Recording. Enter the details of the modification in Part Three of the TGM 120, Record Book for Service Equipment, of the subject vehicles.

E N D